



- Compatible with Socapex "419" and Veam "VSC" connectors
- Rugged die-cast aluminum alloy shells, with black non-conductive finish
- Hard gold plated contacts available in solder & crimp versions
- Integral compression-type strain relief handles wide range of cable size
- Available crimp type crimp extended ground contacts allow make first, break last operation
- Crimp contacts are available for purchase separately

### SOLDER TYPE



- rate voltage: AC 20A 250V
- operating limit voltage: AC 400V
- rated voltage: AC 1500V
- insulation resistance: 2000
- contact resistance: 3
- operating temperature: -40 + 85 degree C
- touch tension: 2 kg
- pressure: 1800 VAC/ Min
- terminal wear: 5000 + connections

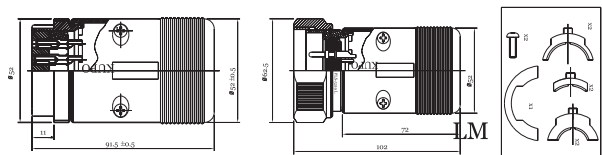

LF

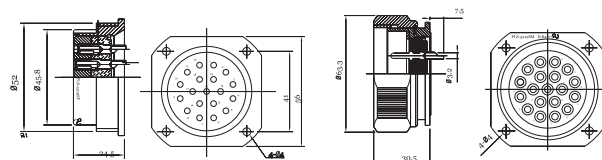

SF

SM

### CRIMP TYPE